

STANLEY®



CONTENTS

DRYWALL SCREWS

2

Fine Thread

Coarse Thread

SELF DRILLING SCREWS

4

Truss Phillips head (Wafer head)

Counter sunk (CSK) Phillips head

PAN Phillips head

Hex head with EPDM seal washer

SELF TAPPING SCREWS

8

Counter sunk (CSK) Phillips head

PAN Phillips head

CHIPBOARD SCREWS

10

Chipboard screws with pozi flat head

WOOD SCREWS

11

Hex Head Coach screws

Counter sunk (CSK) slotted head

Counter sunk (CSK) Phillips head

BLIND RIVETS

14

Aluminum blind rivets

FIXINGS

15

Expansion plugs

Expansion shield anchors (Fix-bolts)

Drop-in anchors

Through bolts (Wedge anchors)

Metal frame anchors

Ceiling wedge anchors

Ceiling wire hanger

NAILS

21

Black hardened steel nails

Hardened steel spiral nails

DRYWALL SCREWS FINE THREAD

Product

Drywall screws with fine thread and Phillips bugle head.



Material

Carbon steel

Application

For fixing of plaster board and gypsum board with light gauge metal sheet and steel studs.

SKU	COO	SURFACE
SF10101-63T	Taiwan	Black phosphate
SF15101-63C	China	Black phosphate

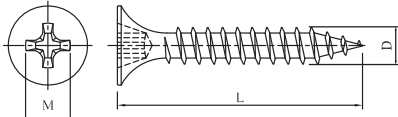
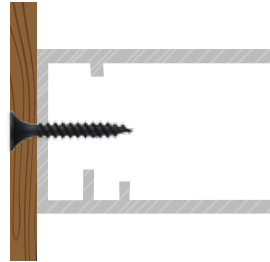

Size (DxL) (Inches)	Size (DxL) (mm)	Recess(M)	Qty/Box (Pcs)
#6x1/2	3.5x13	#2	900
#6x5/8	3.5x16	#2	900
#6x3/4	3.5x19	#2	900
#6x1	3.5x25	#2	900
#6x1-1/4	3.5x32	#2	900
#6x1-1/2	3.5x38	#2	900
#6x2"	3.5x50	#2	450
#6x2-1/2	3.5x65	#2	450
#8x5/8	4.2x16	#2	900
#8x1/2	4.2x13	#2	900
#8x3/4	4.2x19	#2	900

Size (DxL) (Inches)	Size (DxL) (mm)	Recess(M)	Qty/Box (Pcs)
#8x1	4.2x25	#2	900
#8x1-1/4	4.2x32	#2	900
#8x1-1/2	4.2x38	#2	900
#8x2	4.2x50	#2	450
#8x2-1/2	4.2x65	#2	450
#8x3	4.2x75	#2	225
#8x4	4.2x100	#2	225
#10x2	4.8x50	#2	450
#10x3	4.8x75	#2	225
#10x4	4.8x100	#2	225

DRYWALL SCREWS COARSE THREAD

Product

Drywall screws with coarse thread and Phillips bugle head.



Material

Carbon steel

Application

For fixing of plaster board and gypsum board with wood studs

SKU	COO	SURFACE
SF10201-63T	Taiwan	Black phosphate
SF15201-63C	China	Black phosphate

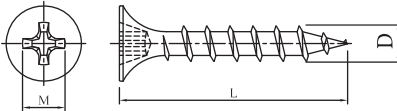
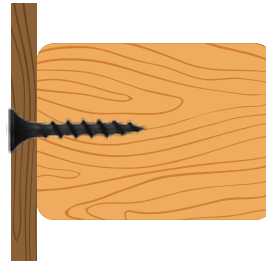

Size (DxL) (Inches)	Size (DxL) (mm)	Recess(M)	Qty/Box (Pcs)
#6x1/2	3.5x13	#2	900
#6x5/8	3.5x16	#2	900
#6x3/4	3.5x19	#2	900
#6x1	3.5x25	#2	900
#6x1-1/4	3.5x32	#2	900
#6x1-1/2	3.5x38	#2	900
#6x2"	3.5x50	#2	450
#6x2-1/2	3.5x65	#2	450
#8x5/8	4.2x16	#2	900
#8x1/2	4.2x13	#2	900
#8x3/4	4.2x19	#2	900

Size (DxL) (Inches)	Size (DxL) (mm)	Recess(M)	Qty/Box (Pcs)
#8x1	4.2x25	#2	900
#8x1-1/4	4.2x32	#2	900
#8x1-1/2	4.2x38	#2	900
#8x2	4.2x50	#2	450
#8x2-1/2	4.2x65	#2	450
#8x3	4.2x75	#2	225
#8x4	4.2x100	#2	225
#10x2	4.8x50	#2	450
#10x3	4.8x75	#2	225
#10x4	4.8x100	#2	225

SELF DRILLING SCREWS TRUSS PHILLIPS HEAD



Product

Self drilling screws with truss Phillips head

Material

Carbon steel

Application

For used in partitioning, electro-mechanical, metal fabrication and shopfitting industries

SKU	COO	SURFACE
SF20401-32T	Taiwan	Zinc plated
SF25401-32C	China	Zinc plated
SF20401-32BT	Taiwan	Black phosphate
SF25401-32BC	China	Black phosphate

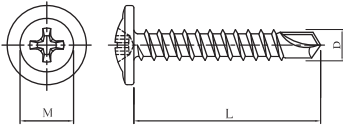
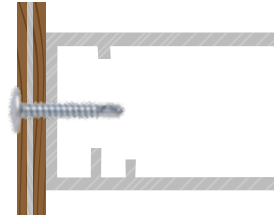

Size (DxL) (Inches)	Size (DxL) (mm)	Recess(M)	Qty/Box (Pcs)
#6x7/16	3.5x11	#2	900
#8x1/2	4.2x13	#2	900
#8x3/4	4.2x19	#2	900
#8x1	4.2x25	#2	900
#8x1-1/4	4.2x32	#2	900
#8x1-1/2	4.2x38	#2	900
#8x2	4.2x50	#2	450
#8x2-1/2	4.2x65	#2	450
#8x3	4.2x75	#2	225

SELF DRILLING SCREWS COUNTER SUNK (CSK) PHILLIPS HEAD



Product

Self drilling screws counter sunk (CSK) Phillips head

Material

Carbon steel

Application

Mostly used in door and window frames with flat surface

SKU	COO	SURFACE
SF20601-45T	Taiwan	Zinc plated
SF25601-45C	China	Zinc plated
SF20601-45BT	Taiwan	Black phosphate
SF25601-45BC	China	Black phosphate

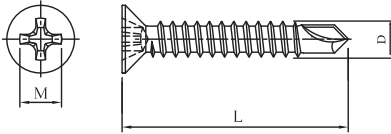

Size (DxL) (Inches)	Size (DxL) (mm)	Recess(M)	Qty/Box (Pcs)
#6x3/4	3.5x19	#2	900
#6x1	3.5x25	#2	900
#6x1-1/4	3.5x32	#2	900
#6x1-1/2	3.5x38	#2	900
#6x2	3.5x50	#2	450
#8x3/4	4.2x19	#2	900
#8x1/2	4.2x13	#2	900
#8x1	4.2x25	#2	900
#8x1-1/4	4.2x32	#2	900
#8x1-1/2	4.2x38	#2	900
#8x2	4.2x50	#2	450
#8x2-1/2	4.2x65	#2	450

Size (DxL) (Inches)	Size(DxL) (mm)	Recess(M)	Qty/Box (Pcs)
#8x3	4.2x75	#2	225
#10x3/4	4.8x19	#2	900
#10x1	4.8x25	#2	900
#10x1-1/4	4.8x32	#2	900
#10x1-1/2	4.8x38	#2	900
#10x2	4.8x50	#2	500
#12x3/4	5.5x19	#3	900
#12x1	5.5x25	#3	900
#12x1-1/4	5.5x32	#3	450
#12x1-1/2	5.5x38	#3	450
#12x2	5.5x50	#3	225

SELF DRILLING SCREWS PAN PHILLIPS HEAD



Product

Self drilling screws with PAN Phillips head

Material

Carbon steel

Application

For attaching thin steel sheet to steel stud, also used for residential steel frame construction

SKU	COO	SURFACE
SF20501-36T	Taiwan	Zinc plated
SF25501-36C	China	Zinc plated
SF20501-36BT	Taiwan	Black phosphate
SF25501-36BC	China	Black phosphate

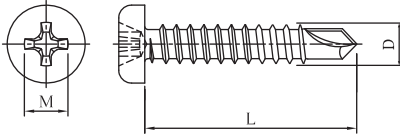

Size (DxL) (Inches)	Size (DxL) (mm)	Recess(M)	Qty/Box (Pcs)
#6x7/16	3.5x11	#2	900
#6x3/4	3.5x19	#2	900
#6x1-1/4	3.5x32	#2	900
#6x1-1/2	3.5x38	#2	900
#8x1/2	4.2x13	#2	900
#8x3/4	4.2x19	#2	900
#8x1	4.2x25	#2	900
#8x1-1/4	4.2x32	#2	900
#8x1-1/2	4.2x38	#2	900
#8x2	4.2x50	#2	900

Size (DxL) (Inches)	Size (DxL) (mm)	Recess(M)	Qty/Box (Pcs)
#8x2-1/2	4.2x65	#2	450
#8x3	4.2x75	#2	450
#10x3/4	4.8x19	#2	900
#10x1	4.8x25	#2	900
#10x1-1/4	4.8x32	#2	900
#10x1-1/2	4.8x38	#2	900
#10x2	4.8x50	#2	500
#10x3	4.8x75	#2	500

HEX HEAD SELF DRILLING SCREWS WITH WASHER



Product

Hex head self drilling screws with EPDM seal washer

Material

Carbon steel

Application

Metal to metal fastening for heavy gauge metal attachment.

SKU	COO	SURFACE
SF20101-11T	Taiwan	Zinc plated
SF25101-11C	China	Zinc plated

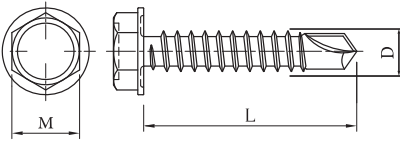

Size (DxL) (Inches)	Size(DxL) (mm)	Drive (M)	Qty/Box (Pcs)
#14x3/4	6.0x19	3/8"	450
#14x1	6.0x25	3/8"	450
#14x1-1/4	6.0x32	3/8"	450
#14x1-1/2	6.0x38	3/8"	225
#14x2	6.0x50	3/8"	225
#14x2-1/2	6.0x65	3/8"	225
#14x3	6.0x75	3/8"	180
#14x4	6.0x100	3/8"	135
#14x5	6.0x125	3/8"	90
#14x6	6.0x150	3/8"	90

SELF TAPPING SCREWS COUNTER SUNK (CSK) PHILLIPS HEAD

Product

Self tapping screws counter sunk (CSK) Phillips head



Material

Carbon steel

Application

Self tapping screws create their own thread whilst being driven in to pre-drilled steel and plastic materials.

Suitable for electrical, mechanical, metal fabrication and assembly.

SKU	COO	SURFACE
SF30201-86T	Taiwan	Nickle plated
SF35201-86C	China	Nickle plated

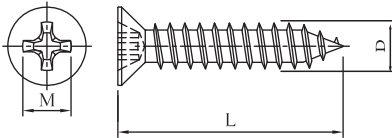

Size (DxL) (Inches)	Size (DxL) (mm)	Recess(M)	Qty/Box (Pcs)
#6x1/2	3.5x13	#2	900
#6x5/8	3.5x16	#2	900
#6x3/4	3.5x19	#2	900
#6x1	3.5x25	#2	900
#6x1-1/4	3.5x32	#2	900
#6x1-1/2	3.5x38	#2	900
#6x2	3.5x50	#2	450
#8x1/2	4.2x13	#2	900
#8x5/8	4.2x16	#2	900
#8x3/4	4.2x19	#2	900
#8x1	4.2x25	#2	900
#8x1-1/4	4.2x32	#2	900
#8x1-1/2	4.2x38	#2	900
#8x2	4.2x50	#2	450
#8x2-1/2	4.2x65	#2	450
#8x3	4.2x75	#2	225

Size (DxL) (Inches)	Size (DxL) (mm)	Recess(M)	Qty/Box (Pcs)
#10x1/2	4.8x13	#2	900
#10x3/4	4.8x19	#2	900
#10x1	4.8x25	#2	900
#10x1-1/4	4.8x32	#2	900
#10x1-1/2	4.8x38	#2	900
#10x2	4.8x25	#2	500
#10x2-1/2	4.8x65	#2	500
#10x3	4.8x75	#2	225
#10x4	4.8x100	#2	225
#12x1	5.5x25	#3	900
#12x1-1/4	5.5x32	#3	450
#12x1-1/2	5.5x38	#3	450
#12x2	5.5x50	#3	225
#12x3	5.5x75	#3	225
#12x4	5.5x100	#3	225

SELF TAPPING SCREWS PAN PHILLIPS HEAD

Product

Self tapping screws PAN Phillips head



Material

Carbon steel

Application

Self tapping screws create their own thread whilst being driven in to pre-drilled steel and plastic materials.

Suitable for electrical, mechanical, metal fabrication and assembly.

SKU	COO	SURFACE
SF30301-86T	Taiwan	Nickle plated
SF35301-86C	China	Nickle plated

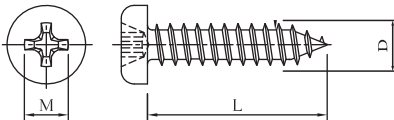

Size (DxL) (Inches)	Size (DxL) (mm)	Recess(M)	Qty/Box (Pcs)
#6x1/2	3.5x13	#2	900
#6x5/8	3.5x16	#2	900
#6x3/4	3.5x19	#2	900
#6x1	3.5x25	#2	900
#6x1-1/4	3.5x32	#2	900
#6x1-1/2	3.5x38	#2	900
#6x2	3.5x50	#2	450
#8x1/2	4.2x13	#2	900
#8x5/8	4.2x16	#2	900
#8x3/4	4.2x19	#2	900
#8x1	4.2x25	#2	900
#8x1-1/4	4.2x32	#2	900
#8x1-1/2	4.2x38	#2	900
#8x2	4.2x50	#2	450
#8x2-1/2	4.2x65	#2	450
#8x3	4.2x75	#2	225

Size (DxL) (Inches)	Size (DxL) (mm)	Recess(M)	Qty/Box (Pcs)
#10x1/2	4.8x13	#2	900
#10x3/4	4.8x19	#2	900
#10x1	4.8x25	#2	900
#10x1-1/4	4.8x32	#2	900
#10x1-1/2	4.8x38	#2	900
#10x2	4.8x25	#2	500
#10x2-1/2	4.8x65	#2	500
#10x3	4.8x75	#2	225
#10x4	4.8x100	#2	225
#12x1	5.5x25	#3	900
#12x1-1/4	5.5x32	#3	450
#12x1-1/2	5.5x38	#3	450
#12x2	5.5x50	#3	225
#12x3	5.5x75	#3	225
#12x4	5.5x100	#3	225

CHIPBOARD SCREWS

Product

Chipboard screws with pozi double flat head



Material

Carbon steel

Application

Ideal for chipboards and wood, but can be used for cabinetry and flooring.

SKU	COO	SURFACE
SF40111-90C	China	Zinc plated

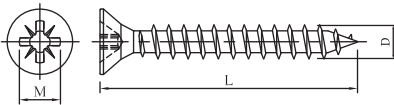

Size (D)	Length (L)	Recess(M)	Qty/Box (Pcs)
M3.0	16MM	#1	900
M3.0	20MM	#1	900
M3.0	25MM	#1	900
M3.0	30MM	#1	900
M3.0	40MM	#1	900
M3.0	50MM	#1	900
M3.5	16MM	#2	900
M3.5	20MM	#2	900
M3.5	25MM	#2	900
M3.5	30MM	#2	900
M3.5	40MM	#2	900
M3.5	50MM	#2	900
M3.5	60MM	#2	900
M4.0	16MM	#2	900
M4.0	25MM	#2	900
M4.0	30MM	#2	900
M4.0	40MM	#2	900
M4.0	50MM	#2	450
M4.0	60MM	#2	450
M4.0	70MM	#2	450
M4.0	80MM	#2	450

Size (D)	Length (L)	Recess(M)	Qty/Box (Pcs)
M5.0	30MM	#1	900
M5.0	40MM	#1	900
M5.0	45MM	#1	900
M5.0	50MM	#1	450
M5.0	60MM	#1	450
M5.0	70MM	#1	450
M5.0	80MM	#2	450
M6.0	80MM	#3	450
M6.0	100MM	#3	225
M6.0	150MM	#3	225

HEX HEAD WOOD SCREWS



Product

Hex head wood screws
(Also known as coach screws)

Material

Carbon steel

Application

Metal to metal fastening for heavy gauge metal attachment.

SKU	COO	SURFACE
SF55101-19C	China	Zinc plated

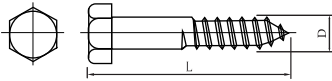

Size (DxL) (Inches)	Size (DxL) (mm)	Qty/Box (Pcs)
5/16x1	8x25	1500
5/16x1-1/2	8x38	1500
5/16x2	8x50	1200
5/16x2-1/2	8x65	1000
5/16x3	8x75	750
5/16x4	8x100	400
3/8x1-1/2	10x38	800
3/8x2	10x50	750
3/8x2-1/2	10x65	700
3/8x3	10x75	700

Size (DxL) (Inches)	Size (DxL) (mm)	Qty/Box (Pcs)
3/8x4	10x100	500
3/8x5	10x125	400
1/4x6	6x150	500
1/2x2	12x25	500
1/2x3	12x75	350
1/2x4	12x100	300
1/2x5	12x125	200
1/2x6	12x150	200
1/2x8	12x200	140

WOOD SCREWS COUNTER SUNK (CSK) SLOTTED HEAD



Product

Wood screws with counter sunk (CSK) slotted head

Material

Carbon steel

Application

For attaching wood with wood

SKU	COO	SURFACE
SF55201-46C	China	Zinc plated
SF55201-46BC	China	Brass plated

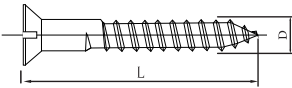

Size (DxL) (Inches)	Size (DxL) (Inches)	Qty/Box (Pcs)
#8x5/8	4.2x16	10000
#8x3/4	4.2x19	10000
#8x1/2	4.2x13	10000
#8x1	4.2x25	10000
#8x1-1/4	4.2x32	10000
#8x1-1/2	4.2x38	10000
#8x2	4.2x50	10000
#8x2-1/2	4.2x65	10000
#8x3	4.2x75	10000
#10x5/8	4.8x16	5000

Size (DxL) (Inches)	Size (DxL) (Inches)	Qty/Box (Pcs)
#10x3/4	4.8x19	5000
#10x1	4.8x25	5000
#10x1-1/4	4.8x32	5000
#10x1-1/2	4.8x38	5000
#10x2	4.8x50	5000
#10x3	4.8x75	2500
#10x4	4.8x100	2500
#12x1	5.5x25	5000
#12x1-1/2	5.5x38	2500
#12x2	5.5x50	2500

WOOD SCREWS COUNTER SUNK (CSK) PHILLIPS HEAD



Product

Wood screws with counter sunk (CSK) Phillips head

Material

Carbon steel

Application

For attaching wood with wood

SKU	COO	SURFACE
SF55401-46C	China	Zinc plated
SF55401-46BC	China	Brass Plated

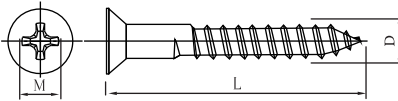

Size (DxL) (Inches)	Size (DxL) (Inches)	Recess(M)	Qty/Box (Pcs)
#8x5/8	4.2x16	#2	10000
#8x3/4	4.2x19	#2	10000
#8x1/2	4.2x13	#2	10000
#8x1	4.2x25	#2	10000
#8x1-1/4	4.2x32	#2	10000
#8x1-1/2	4.2x38	#2	10000
#8x2	4.2x50	#2	10000
#8x2-1/2	4.2x65	#2	10000
#8x3	4.2x75	#2	10000
#10x5/8	4.8x16	#2	5000

Size (DxL) (Inches)	Size (DxL) (Inches)	Recess(M)	Qty/Box (Pcs)
#10x3/4	4.8x19	#2	5000
#10x1	4.8x25	#2	5000
#10x1-1/4	4.8x32	#2	5000
#10x1-1/2	4.8x38	#2	5000
#10x2	4.8x50	#2	5000
#10x3	4.8x75	#2	2500
#10x4	4.8x100	#2	2500
#12x1	5.5x25	#3	5000
#12x1-1/2	5.5x38	#3	2500
#12x2	5.5x50	#3	2500

ALUMINIUM BLIND RIVETS

Product

Aluminium blind rivets



Material

Sleeve: Aluminium

Mandrel: Steel galvanized

Application

For used in sheet metal fabrication and partitioning

SKU	COO
SF70101-26C	China

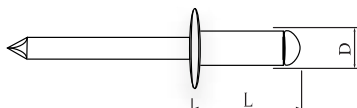

Diameter (D)	Length (L)	Qty/Box (Pcs)
3.2MM	6MM	800
3.2MM	8MM	800
3.2MM	10MM	800
3.2MM	12MM	800
3.2MM	14MM	800
3.2MM	16MM	800
3.2MM	19MM	800
3.2MM	25MM	800
4.0MM	8MM	800
4.0MM	10MM	800
4.0MM	12MM	800
4.0MM	14MM	800
4.0MM	16MM	800

Diameter (D)	Length (L)	Qty/Box (Pcs)
4.0MM	19MM	800
4.0MM	25MM	800
4.8MM	8MM	800
4.8MM	10MM	800
4.8MM	12MM	800
4.8MM	14MM	800
4.8MM	16MM	400
4.8MM	19MM	400
4.8MM	22MM	400
4.8MM	25MM	400
4.8MM	30MM	400
4.8MM	35MM	400
4.8MM	40MM	200

EXPANSION PLUG

Product
Expansion plug



Material
Nylon

Application
Suitable for all solid building materials as: concrete, full brick, clinker brick, stone, etc.

SKU	COO
SF55201-46C	China

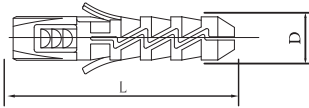

Size (D)	Length (L)	Qty/Box (Pcs)
6MM	30MM	100
8MM	40MM	100

Installation:

- 1: Drill a hole with correct diameter and depth
- 2: Clean the drilled hole
- 3: Insert plug - use a hammer if necessary
- 4: Use screw size as recommended and tighten screw till secure.

EXPANSION SHIELD ANCHOR (FIX BOLT)



Product

Expansion shield anchor
(Also known as fix bolt)

Material

Carbon steel

Application

For racking & storage, wall plates and lift guide rails.

SKU	COO	SURFACE
SF80401-6C	China	Zinc plated



Size (D)	Length (L)	HEX Socket (H)	Qty/Box (Pcs)
M6	45MM	10MM	100
M8	55MM	13MM	50
M10	65MM	17MM	30
M12	90MM	19MM	20
M16	110MM	24MM	9

Installation:

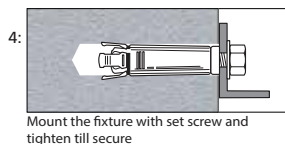
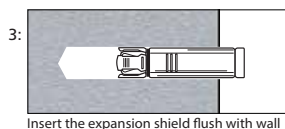
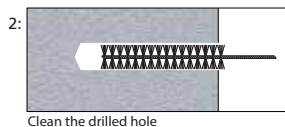
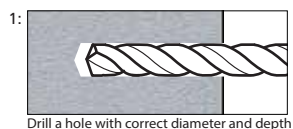

DROP-IN ANCHOR



Product

Drop-in anchor with internal thread
(Also known as Uni-fix)

Material

Carbon steel

Application

For fixing of pipes, suspended ceilings, various elements with use of threaded rods or hooks with metric thread, etc.

SKU	COO	SURFACE
SF80501-5C	China	Zinc plated

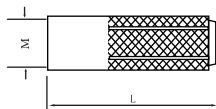

Size (M)	Length (L)	Qty/Box (Pcs)
M6	25MM	100
M8	30MM	100
M10	40MM	50
M12	50MM	50
M16	65MM	10

Installation:

- 1: Drill a hole with correct diameter and depth
- 2: Clean the drilled hole
- 3: Insert the anchor flush with wall
- 4: Mount the fixture with set screw and tighten till secure

THROUGH BOLTS



Product

Through bolts
(Also known as wedge anchors)

Material

Carbon steel

Application

For fixing of stadium seating, brick ties, industrial doors & gates, steel & timber framework and pallet racking.

SKU	COO	SURFACE
SF80801-14C	China	Zinc plated

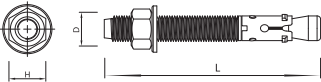

Size (D)	Length (L)	Wrench (H)	Qty/Box (Pcs)
M8	80MM	13MM	100
M8	100MM	13MM	100
M8	120MM	13MM	100
M10	80MM	17MM	100
M10	100MM	17MM	50
M10	120MM	17MM	50
M10	150MM	17MM	150
M10	200MM	17MM	25
M12	100MM	19MM	50
M12	120MM	19MM	50
M12	150MM	19MM	50
M16	100MM	24MM	50
M16	120MM	24MM	25
M16	150MM	24MM	25

Installation:

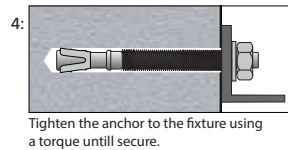
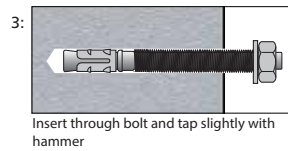
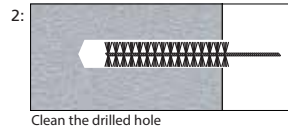
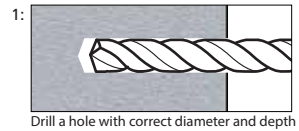

METAL FRAME ANCHOR



Product

Metal frame anchor

Material

Sleeve: Steel Sheet Metal

Bolt: Carbon steel

Application

For fixing of windows and door frames.

SKU	COO	SURFACE
SF80301-5C	China	Zinc plated

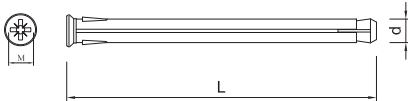

Size (D)	Length (L)	Recess (M)	Qty/Box (Pcs)
M10	72MM	PZ3	100
M10	92MM	PZ3	100
M10	112MM	PZ3	100
M10	132MM	PZ3	100
M10	152MM	PZ3	100

Installation:

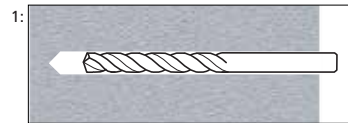

Drill a hole with correct diameter and depth

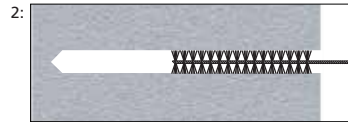

Clean the drilled hole



Insert anchor and tap slightly with hammer



Tighten the anchor to the fixture until secure.

CEILING WEDGE ANCHOR



Product

Ceiling wedge anchor

Material

Carbon steel

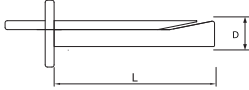

Application

For installation of lightweight ceiling and suspended ceiling.

SKU	COO	SURFACE	SIZE (D)	LENGTH (L)	Qty/Box (Pcs)
SF80601-1C	China	Zinc plated	6mm	40mm	100

Installation:

- 1: Drill a hole of required diameter.
- 2: Place the item to fixed on the surface of ceiling.
- 3: Insert anchor in drilled hole and hammer in the anchor.

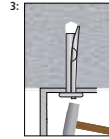
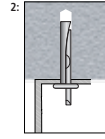

CEILING WIRE HANGER

Product

Ceiling wire hanger



Material

Carbon steel

Application

For installation of lightweight ceiling and temporary installations in concrete.

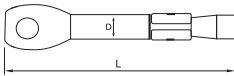

SKU	COO	SURFACE	SIZE (D)	LENGTH (L)	Qty/Box (Pcs)
SF80701-1C	China	Zinc plated	6mm	60mm	100

Installation:

- 1: Drill a hole of required diameter.
- 2: Hammer in the anchor.
- 3: When the eye of anchor is exposed to tension, it will expand in the material.

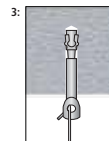
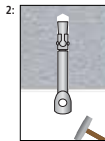
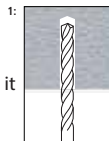

BLACK HARDENED STEEL NAIL

Product

Hardened steel nails with round head and diamond point



Material

Hardened steel

Application

Fixing soft and hard wood in concrete, brick, stone and masonry.

SKU	COO	SURFACE
SF60101-6C	China	Black phosphate

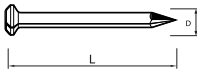

Size (D)	Length (L)	Qty/Box (Pcs)
2MM	25MM	10000
3MM	40MM	6000
3MM	50MM	4000

Size (D)	Length (L)	Qty/Box (Pcs)
3MM	60MM	3500
3MM	70MM	3500
3MM	100MM	2000

HARDENED STEEL SPIRAL NAIL

Product

Hardened steel spiral nails with flat head and diamond point



Material

Hardened steel

Application

Fixing soft and hard wood in concrete, brick, stone and masonry.

SKU	COO	SURFACE
SF60101-6C	China	Zinc plated



Size (D)	Length (L)	Weight/Box (Kg)
3.0MM	25MM	15
3.2MM	40MM	15
3.6MM	50MM	15

Size (D)	Length (L)	Weight/Box (Kg)
4.0MM	60MM	15
4.2MM	70MM	15
4.5MM	100MM	15

NOTES

A series of 21 horizontal dashed lines for writing notes.

STANLEY®



STANLEY®

©2017 Stanley Black & Decker, Inc.
STANLEY® and STANLEY® logo are trademarks of
Stanley Black & Decker, Inc. or an affiliate thereof
and are used under license.

Distributed by:
PAG Ltd.
Tortola British Virgin Island.
Toll free: 800 7826539
www.stanley-fasteners.com

